



Perth, Australia

# PERO1/CAMPUS

Scalability and Optionality in Australia's Fourth Most Populated City

CAPACITY  
**24<sup>MW</sup>**

---

CAMPUS SIZE  
**2.2<sup>HECTARES</sup>**

---



The world runs on data. Data runs on STACK. | [sales@stackinfra.com](mailto:sales@stackinfra.com)

## Grow Your Reach Across Australia and Southeast Asia

Perth, located on Australia's west coast, is the fourth most populated city in the country. This strategic market offers access to significant sub-sea infrastructure, offering direct access to Southeast Asia and major east coast centers such as Sydney and Melbourne. This region enables hyperscalers and large enterprises to address demand growth specifically within the Resources & Mining sectors along with both State and Federal Government markets.

Located in Wangara, a light industrial suburb of Perth, STACK's Perth data center campus offers PER01A, an 8MW building, and PER01B, a 16MW building, for a combined total of 24MW with block redundancy across the two diverse buildings, delivering capacity and reliability on the fast-paced timeline hyperscalers and large enterprises need. The buildings' efficient technologies offer market-leading PUE and water usage to help achieve client sustainability goals. With robust access to power via diverse feeders, the campus offers scalability and reliability for higher rack densities and floor loading specifications. The site enables hyperscalers and enterprise clients to address the evolving requirements in Australia and the APAC region more broadly.

**Central Location:** Utilize the significant sub-sea infrastructure to gain direct access to Southeast Asia and major east coast centers such as Sydney and Melbourne.

**Significant Growth:** Answer the ever-increasing call for more data processing and storage with 24MW from this strategic campus, ideally situated for reach and scalability.

**Flexible Options:** Choose from READYSTACK capacity for immediate availability, POWERSTACK shell deployments for optimal control, and HYPERSTACK build-to-suit for ultimate flexibility.

**Comprehensive Connectivity:** Capitalize on immediate proximity to major long haul fiber carriers and high-capacity dark fiber for low-latency connectivity.

**Future-Proof Design:** Implement higher rack density and floor loading specifications with our scalable design to address the evolving requirements in Australia and the APAC region.

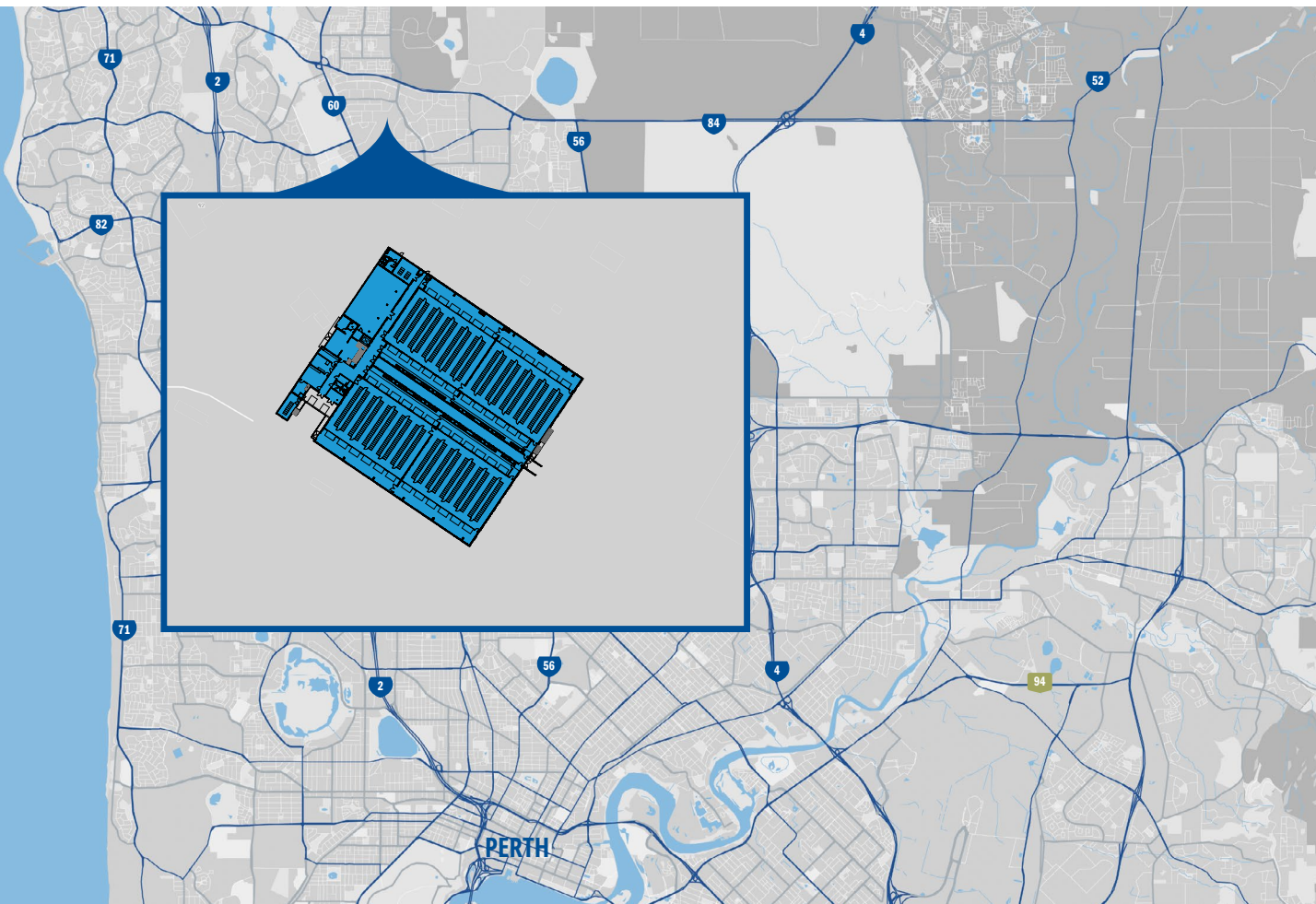

## Address high demand with fast growth in this key market.

### OPTIONS AVAILABLE

## HYPER STACK

BUILD-TO-SUIT

#### Built to scale.

Our HYPERSTACK build-to-suit option gives you total flexibility and control. Choose our purpose-built Basis of Design as a starting point, or work with the STACK team to develop a customized solution for your company to grow as fast as you need.

## POWER STACK

POWERED SHELL

#### A flexible foundation.

POWERSTACK powered shell solutions are customizable base buildings designed for rapid deployments of right-sized capacity on demand. They're fiber-provisioned, fit-out ready, and available fast.

## READY STACK

COMMISSIONED CAPACITY

#### Plug in and go.

When you need capacity even faster, you need READYSTACK. These rack-ready data halls are purpose built for your immediate needs with pre-installed racks, connectivity and power. You bring the equipment. We've got everything else.

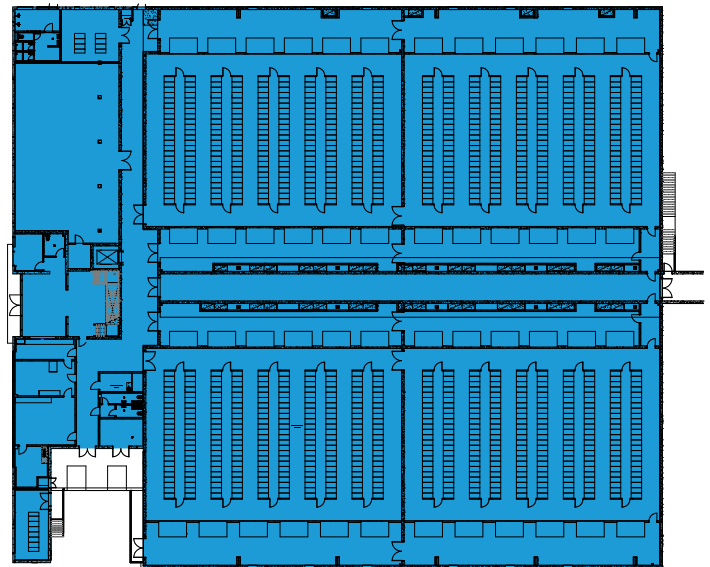

## CAPACITY

### Campus Size

- 2.2 hectares (5.5 acres)

### Total Capacity

- 24MW Total Campus Capacity (PERO1A - 8MW & PERO1B - 16MW)

### Deployments

- POWERSTACK™: Immediately available shell capacity
- READYSTACK™: RackReady® data halls
- HYPERSTACK™: Build-to-suit

## POWER & RELIABILITY

### Western Power

- 22kV N+1 voltage lines

### Electrical Redundancy (Generators / UPS)

- N+1 Block Redundant

### Fuel Storage

- 48 hours of operation

### PDU

- Client-dedicated PDU distribution

### BMS Controls

- Client access to BMS portal

## CONNECTIVITY

### Diversity

- 2 Meet-Me-Rooms with diverse fiber entrances

### Carrier Availability

- Vocus
- Optus
- Telstra
- TPG

## COOLING & EFFICIENCY

### Cooling

- N+2 air-cooled chillers

### Floor Loading

- 20kN/m<sup>2</sup> in data halls and access route floors

### Annualized PUE target 1.30

## SAFETY & SECURITY

### Security

- 24 x 7 on-site security personnel
- Dual-factor biometric access
- CCTV coverage with 93-day retention
- Secure vehicle gates with badge access
- Perimeter fencing
- Tenant specific security
- Separate Yellow and Red Zone access elevators
- High Security SCEC security zones including perimeter fencing
- Type 1A alarm system

### Fire Protection

- Dual smoke detection including VESDA/HSSD
- Double Interlocked Preaction Suppression System
- Located in an area of minimal flood hazard

## CERTIFICATIONS SUPPORTED

- ISO Compliance
- ISO 9001
- ISO 14001
- ISO 27001
- ISO 45001
- PCI/DSS - Financial
- SSAE SOC 2 Type I and II
- SCEC SPSF Zone 4 or higher
- Federal Government Strategic Hosting Provider (DTA)
- DISP Certified - Defence Industry Security Program

## AMENITIES

### Work Space

- Conference and break rooms
- Complimentary WiFi
- Shared and dedicated office space

### Storage

- Shared and private storage/staging

### Client Conveniences

- Access to rail
- Showers
- Bicycle storage
- Vehicle Parking
- Multi-bay secure loading docks
- 20 foot container capabilities
- 5 ton and 1.6 ton elevators
- Restaurants and shops nearby

STACK provides digital infrastructure to scale the world's most innovative companies. With a client-first approach, STACK delivers a comprehensive suite of campus, build-to-suit, colocation, and powered shell solutions in the Americas, EMEA and APAC regions. With robust existing and flexible expansion capacity in the leading availability zones, STACK offers the scale and geographic reach that rapidly growing hyperscale and enterprise companies need. The world runs on data. And data runs on STACK.